

Fig. M733DR Ductile Iron Globe Valves with Double Regulating Feature

FEATURES AND BENEFITS

- Robust iron body materials for long service life
- Precise flow regulation
- Flanged with handwheel – easy to install and operate
- Positive flow control at all handwheel settings



MATERIAL SPECIFICATION

Component	Material	Specification	
		BS EN	ASTM
Stem	316 SS	10088 X5CrNiMo17-12-2	A276 316
Gland (200 to 300mm)	Cast Iron	1561 GRADE 250	
Gland Nut	Mild Steel		
Bonnet	Ductile Iron		536 65-45-12
Bonnet Gasket	Asbestos Free		
Disc	Cast Iron	1561 GRADE 250	
Disc Insert	PTFE		
Disc Coating	EPDM		
Seat Ring	Bronze	1982 CC491K	
Body	Ductile Iron		536 65-45-12
Packing	Asbestos Free		

DIMENSIONAL DRAWINGS

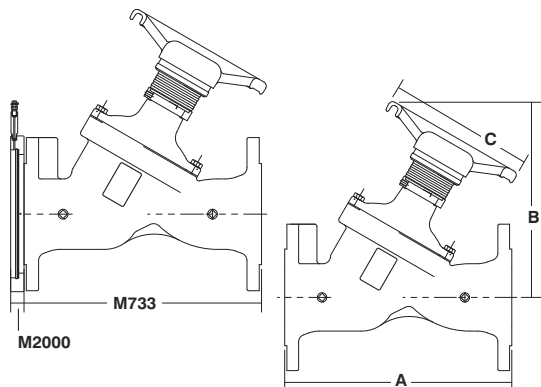

DIMENSIONS AND WEIGHTS

Nom Size	mm	250	300
A	mm	730	850
B	mm	575	645
C	mm	420	420
Weight	kg	192	251

For Commissioning Valve Coefficients please refer to pages 47-49.

Every effort has been made to ensure that the information contained in this publication is accurate at the time of publishing. Hattersley Ltd assumes no responsibility or liability for typographical errors or omissions or for any misinterpretation of the information within the publication and reserves the right to change without notice.

PRESSURE/ TEMPERATURE RATING

16 bar from -10 to 120°C

TEST PRESSURES (HYDRAULIC)

Shell: 24 bar

Seat: 17.6 bar

SPECIFICATION

Conforms to BS 7350: 1990.

Inside screw, non-rising stem.

Copper alloy trim.

Flanged to BS EN 1092-2 PN16.

Fitted with regulating disc, double regulating device and indicator.



Use with figure M2000 to make Commissioning Set M2733

